

Button Switch $\Phi 22$

Quality as the root · Service as the base



LA36A Series Of Metal Coil Button Switch



GENERAL

1. The head of this series product is metal coil, operating part and middle connection adopt convenient and quick installation way. It can be used under every terrible condition because of the lock, fall and vibration resistance.
2. The contact is a self-cleaning flat pressing quick action structure; The switch base can be assembled by building blocks, and can combine up to 8 switch elements according to requirements, which can meet the requirements of various specific control circuits.
3. Installation dimensions: $\Phi 22$ mm.
4. Function: momentary, maintained, illuminated button, selector switch, key-lock selector switch, emergency, mushroom.
5. Contact combination: 1NO1NC/2NO/2NC/1NO/1NC.
6. IP degree: IP40.

DISASSEMBLY AND INSTALLATION

1. Disassembly steps

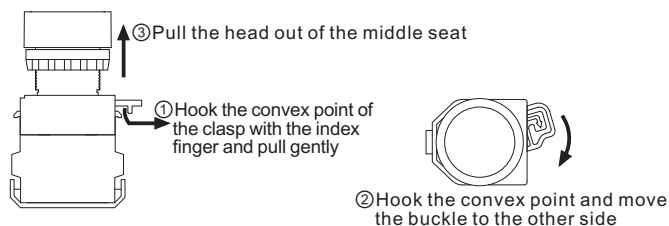

2. Installation steps

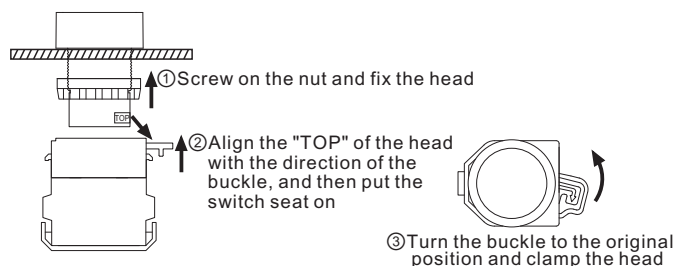

LAMP SPECIFICATIONS

Lamp type	Two-way LED lamp		
Rated voltage	AC/DC 6V	AC/DC 12V	AC/DC 24V
	AC/DC 36V	AC/DC 48V	AC/DC 110V
	AC/DC 220V	AC/DC 380V	
	AC 110V	AC 220V	AC 380V
Lamp color	R ● G ● Y ● B ● W ○		
Life	≥40000h		

SPECIFICATION

Operating temperature		-25°C~+55°C(Ice free)
Operating humidity		45~85%RH
Contact resistance		≤50mΩ
Insulation resistance		≥100MΩ
Dielectric strength		1890VAC/50Hz/60s
Vibration resistance		50Hz, Amplitude 1.0mm
Shock resistance		> 10g
Mechanical life	momentary	≥2,000,000 times
	maintained, selector switch	≥1,000,000 times
	key-lock selector switch, emergency	≥500,000 times
Electrical life		≥200,000 times
Terminal		Screw connection, wire diameter: 2×1.5mm Largest insert terminal: 6.3×0.8mm

SWITCH RATING

Rated insulation voltage(Ui)			660V				
Thermal current(Ith)			10A				
Rated voltage(Ue)			24V	48V	110V	220V	380V
Rated current (Ie)	AC-15 50/60Hz	Resistive load	10A	-	10A	10A	-
		Inductive load	10A	-	6A	3A	2A
	DC-13	Resistive load	8A	4A	2.2A	1.1A	-
		Inductive load	6A	2A	1.2A	0.6A	-
Contact Material			Silver alloy				

Minimum adaptive load: 3V AC/DC 5mA (reference value) (The scope of usage depends on the usage environment and load type)

Button Switch Φ22

Quality as the root · Service as the base



LA36A Series Of Metal Coil Button Switch

CONTACT DESCRIPTION OF SWITCH BASE

The number of the black label on the switch base :

- The first digit "1" indicates the first pair of contacts on the first switch base, and "2" indicates the second pair of contacts on the first switch base.
- The second digit "1, 2" refers to two terminals of the NC contact, "3, 4" refers to two terminals of the NO contact point.

Contact code	11	20	02	10	01
Contact name	1NO1NC	2NO	2NC	1NO	1NC
State diagram					

WORKING POSITION AND CORRESPONDING CONTACT STATE OF SELECTOR SWITCH

① Opening and closing state diagram of two positions and corresponding contacts



2 position maintained 2 position momentary

S/N	Model		
1	LA36A-11■/2		
2	LA36A-20■/2		
3	LA36A-02■/2		
4	LA36A-22■/2		
5	LA36A-31■/2		
6	LA36A-13■/2		
7	LA36A-40■/2		
8	LA36A-04■/2		

② Opening and closing state diagram of three positions and corresponding contacts

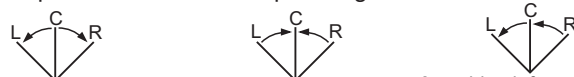

3 position maintained 3 position momentary 3 position left maintained right momentary

S/N	Model			
1	LA36A-11■/3			
2	LA36A-20■/3			
3	LA36A-02■/3			
4	LA36A-22■/3			
5	LA36A-31■/3			
6	LA36A-13■/3			
7	LA36A-40■/3			
8	LA36A-04■/3			

IMPLICATION OF TYPE

LA36A-	⊙	■/	□	▲	△	○
Code of series	Contact :	Operating type:	Work position of selector switch:	Special requirements function:	Lamp voltage:	Color :
	11: 1NO1NC 20: 2NO 02: 2NC 10: 1NO 01: 1NC 22: 2NO2NC 40: 4NO NO and NC contacts can be combined as required	BN:flat momentary BNZS:flat maintained DN:flat illuminated momentary DNZS:flat illuminated maintained GN: high momentary GNZS: high maintained M: mushroom momentary MZS: mushroom maintained MD:mushroom illuminated momentary MZSD:mushroom illuminated maintained X: selector switch XB:long handle selector switch XD: illuminated selector switch Y: key-lock selector switch	21:2 position maintained 22:2 position momentary 31:3 position maintained 33:3 position momentary 32:3 position left maintained right momentary	No letters: convention FH:custom symbol K:anti-interference illuminated button	AC/DC 6V AC/DC 12V AC/DC 24V AC/DC 36V AC/DC 48V AC/DC 110V AC/DC 220V AC/DC 380V AC 110V AC 220V AC 380V	■R ■G ■Y ■B □W ■BL

Note: the above table is only for model explanation, and some model combinations have no actual products. See the following figure for specific products.

Button Switch $\Phi 22$

Quality as the root · Service as the base



LA36A Series Of Metal Coil Button Switch

PRODUCT SELECTION (The following models are conventional models. Please consult other models for special requirements)

<div> <div> <div>○ Contact</div> <div>11, 20, 02, 10, 01, 22, 40, 04</div> </div> <div> <div>△ LED voltage</div> <div>(AC/DC) 3V, 6V, 12V, 24V, 36V, 48V, 110V, 220V (AC) 110V, 220V, 380V</div> </div> </div>		<div> <div>○ Color</div> <div>R G Y B W BL</div> </div>	
Picture	Operation	Model	Shape Dimensions
	Flat momentary	LA36A-11BN○	
	Flat maintained	LA36A-11BNZS○	
	Flat illuminated momentary	LA36A-11DN△○	
	Flat illuminated maintained	LA36A-11DNZS△○	
	High momentary	LA36A-11GN○	
	High maintained	LA36A-11GNZS○	
	High illuminated momentary	LA36A-11GDN△○	
	High illuminated maintained	LA36A-11GDNZS△○	
	Mushroom momentary	LA36A-11M○	<div>Selective Color○: R G Y</div>
	Mushroom maintained	LA36A-11MZS○	
	Mushroom illuminated momentary	LA36A-11MD△○	<div>Selective Color○: R G Y</div>
	Mushroom illuminated maintained	LA36A-11MZSD△○	

Quality as the root · Service as the base

PRODUCT SELECTION (The following models are conventional models. Please consult other models for special requirements)

⊙ Contact 11, 20, 02, 10, 01, 22, 40, 04

△ LED voltage	(AC/DC) 3V、6V、12V、24V、36V、48V、110V、220V (AC) 110V、220V、380V
---------------	--

☐ Color

CHINA YIJIA INDUSTRIAL ELECTRICAL CO.,LTD. www.yijiabutton.com / 4