

Metal Button $\Phi 19$ (Short Type)

Quality as the root · Service as the base



YJ-GQ19 Series Short Type Metal Button

GENERAL

1. Installation dimensions: $\Phi 19$ mm.
2. Head shape: flat round、high round、spherical.
3. Wiring mode: screw terminal、pin terminal.
4. Operation: momentary.
5. Contact: 1NO.
6. IP Degree: IP65
7. The material of Keypad: stainless steel.
8. The material of shell: chrome plating of brass、stainless steel、aluminum alloy plating.
9. The material of base: PA66.

LAMP SPECIFICATIONS

Lamp type	Two-way LED lamp	
Rated voltage	AC/DC 3V	AC/DC 6V
	AC/DC 12V	AC/DC 24V
	AC/DC 36V	AC/DC 48V
	AC/DC 110V	AC/DC 220V
Lamp color	R ● G ● Y ● B ● W ○	
Life	≥40000h	

SWITCH RATING

Rated voltage(Ue)		12V	24V	110V	220V	
Rated current (Ie)	AC-15 50/60Hz	Resistive load	5A	5A	5A	3A
		Inductive load	5A	5A	3A	2A
	DC-13	Resistive load	1A	1A	0.2A	0.1A
		Inductive load	0.5A	0.5A	0.2A	0.1A

SPECIFICATION

Operating temperature	-25°C~ +55°C (Ice free)
Operating humidity	45-85%RH
Contact resistance	≤50mΩ
Insulation resistance	≥1000MΩ
Dielectric strength	1500VAC/50Hz/60s
Vibration resistance	50Hz, Amplitude 1.2mm
Shock resistance	> 10g
Solder heat resistance	when 320°C (or 30W electric iron), no more than 3 seconds
Switch rating	250V/5A
Mechanical life	≥1,000,000times
Electrical life	≥100,000times
Nut torque	about 0.6Nm
Operation stroke	about 2mm
Operating pressure	about 5N

CONTACT DESCRIPTION

Type	1NO
Diagram	
Sign	
Note	Double break-points with two terminals slow contact switch

CONTACT DESCRIPTION

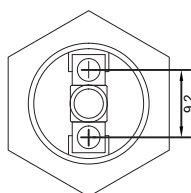

Screw terminal

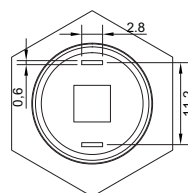

Pin terminal

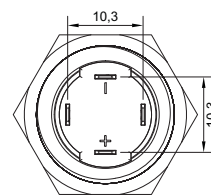

Illuminated button: pin terminal

IMPLICATION OF TYPE

YJ-GQ19□	★	-○	▲/	■/	☆	△	○
Code of series□: No letters : no lamp type B: with lamp type	Head shape: B: spherical F: flat round H: high round	Contact: 10: 1NO	Operation: No letters : momentary E: momentary with ring lamp EP: momentary with ring lamp and luminous power logo	Wiring mode: No letters : screw terminal J: pin terminal	Shell material: N: chrome plating of brass S: stainless steel A: aluminum alloy plating	Lamp voltage: 3V 6V 12V 24V 36V 48V 110V 220V	Color : R ● G ● Y ● B ● W ○

Note: the above table is only for model explanation, and some model combinations have no actual products. See the following figure for specific products.

Metal Button $\Phi 19$ (Short Type)











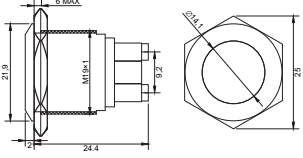

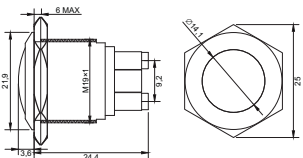

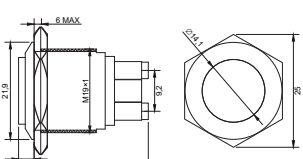
YJ-GQ19 Series Short Type Metal Button

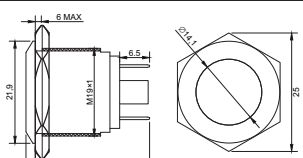
PRODUCT SELECTION

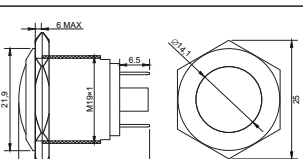
☆shell material N: Chrome plating of brass / S: Stainless steel / A: Aluminum alloy plating

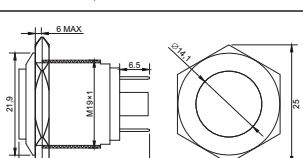
△ LED voltage 1.8V、3V、6V、12V、24V、36V、48V、110V、220V

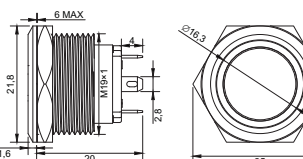
○LED color **R** **G** **Y** **B** **W**

Picture	Operation	Model	Shape Dimensions
	Flat, momentary (screw terminal)	YJ-GQ19F-10/☆	
	Spherical, momentary (screw terminal)	YJ-GQ19B-10/☆	
	High, momentary (screw terminal)	YJ-GQ19H-10/☆	
	Flat, momentary (pin terminal)	YJ-GQ19F-10/J/☆	
	Spherical, momentary (pin terminal)	YJ-GQ19B-10/J/☆	
	High, momentary (pin terminal)	YJ-GQ19H-10/J/☆	
	Flat, momentary ring lamp	YJ-GQ19BF-10E/J/☆△○	
	Flat, momentary ring lamp with luminous power logo	YJ-GQ19BF-10EP/J/☆△○	